



Exhaust Systems Engine Mounts Carb Air Boxes

Shrouds • Seats • Piston • Turbine • Radial • Vintage • And More...



CESSNA 310 I THRU Q

EARLY MODEL UNDERWING WITH CONTINENTAL IO-470 ENGINE

Item	Part Number	Description
1	0850730-1/27	RISER LEFT HAND AFT
2	0850600-43/89	RISER LEFT HAND CTR
3	0850600-49/91	RISER LEFT HAND FWD
4	0850730-2/28	RISER RIGHT HAND AFT
4	0850730-8	RISER RIGHT HAND AFT W/MIXTURE CONTROL
5	0850600-44/88	RISER RIGHT HAND CTR
6	0850600-50/90	RISER RIGHT HAND FWD
-	628260	GASKET
-	0850440-11	INDUCTION AIR BOX SN ^{310H0001} _{310K0001}
-	0850442-9	INDUCTION AIR BOX SN ^{310K0001} _{310K0245}
-	0850442-5	INDUCTION AIR BOX SN ^{310L0001} _{310L0207}
-	0850344-55	INDUCTION AIR CANISTER LH SN ^{310N0001} _{310N0198}
-	0850344-54	INDUCTION AIR CANISTER RH SN ^{310N0001} _{310N0198}
-	0850344-57	INDUCTION AIR CANISTER LH SN ^{310P001} _{310Q1160}
-	0850344-56	INDUCTION AIR CANISTER RH SN ^{310P001} _{310Q1160}
-	VARIOUS	SEAT BASE

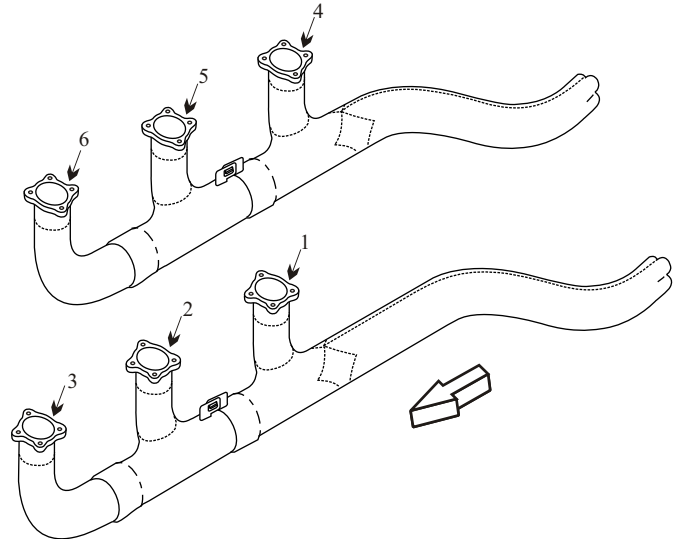

- Inspect tailpipes for internal pitting and wall thickness especially at the outside radius, which is the thin section, and at support bracket.

(toll free) 1-888-388-8803 1-780-447-5955 Fax: 1-780-447-5980
 sales@acornwelding.com parts@acornwelding.com www.acornwelding.com